

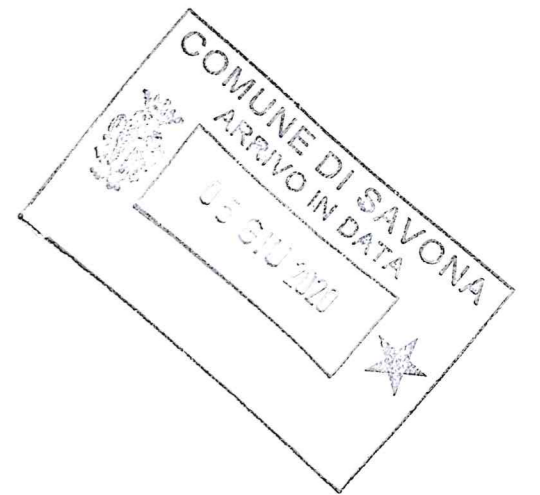

PIANTA STATO PROGETTO

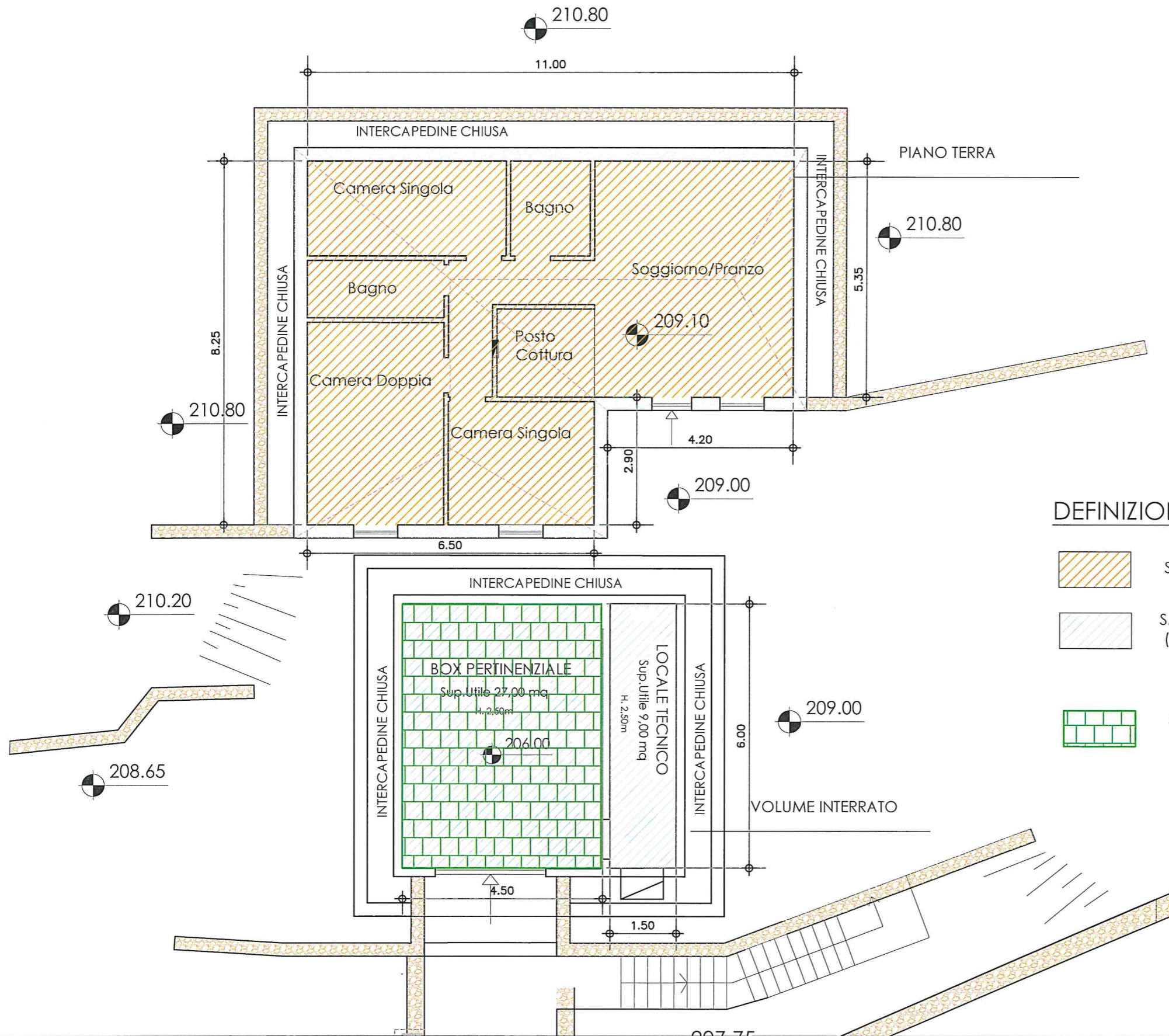

DEFINIZIONI UNIFORMI ART.4.33-ST1 DEL P.U.C.

-  S.A.= SUPERFICIE AGIBILE FABBRICATO = MQ. 77,70
-  S.ACC.= SUPERFICIE ACCESSORIA = MQ. 36,00
(LOCALE TECNICO MQ 9,00+ BOX PERTINENZIALE MQ 27,00)
-  SUP. AGIBILE PARCHEGGIO PERTINENZIALE =
= 35% DELLA S.A. FABBRICATO = MQ. 27,00

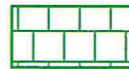